

# THE HCC EDUCATIONAL FOUNDATION FY 2018 DONOR REPORT

## FY18 HCC EDUCATIONAL FOUNDATION BOARD OF DIRECTORS

**Sean Keller**  
*Chairperson*  
Freedom Consulting Group

**Barb Van Winkle**  
*Vice Chairperson*  
Nancy Adams Personnel

**Mary Cannon**  
*Treasurer*  
Mary Cannon and  
Associates, LLC

**Kenneth Solow**  
*Assistant Treasurer*  
Pinnacle Advisory Group, Inc.

**Kathleen Hetherington, Ed.D.**  
*Secretary and HCC  
President*  
Howard Community College

**Jonathan Ahn, Esq.**  
*Attorney*

**Nancy Calder**  
*Faculty Representative*  
Howard Community College

**Charlie Camp**  
M&T Bank

**Matthew D'Amico**  
Design Collective

**George Doetsch**  
Apple Ford Lincoln

**Michael Drummond**  
Harkins Builders

**Sean Hough**  
Sandy Spring Bank

**Christopher Marasco**  
*Trustee Liaison*  
Revere Bank

**Benjamin Mobley**  
PNC Wealth Management

**Thomas Munns**  
CareFirst BlueCross  
BlueShield

**Lisa Olivier**  
MileOne Autogroup

**Eric Regelin**  
GRANIX, LLC

**Bruce Rothschild**  
*Attorney*

**Alexander Ruygrok**  
Boulard & Brush, LLC

**Danielle Smith**  
Baltimore Gas and Electric

**Quentin Smith**  
Praxis Engineering

**Allen Stott**  
Chesapeake Corporate  
Advisors, LLC

**Robin Thomas**  
BB&T Wealth

**EXECUTIVE DIRECTOR**  
**Missy Matthey**  
Howard Community College

## Message from the New Chairperson

Howard Community College plays a critical role in our community, helping students achieve a better career and a brighter future. Working in collaboration with the college, the HCC Educational Foundation (HCCEF) develops community partnerships and individual support to fund scholarships and support services for students. Nearly half of all students need some form of financial assistance during their time at HCC, and HCCEF scholarships create opportunities for students that they may not have had otherwise.



Looking back on the past fiscal year, HCCEF raised a total of \$2,055,343, exceeding our fundraising goal by more than \$500,000! This accomplishment was only possible with the contributions of the donors listed in our annual report. Every donation funds pathways to success, and there are countless examples of how scholarships make a difference to students and their families.

For Jackie, managing her own business meant working long hours every day. After experiencing quality nursing care when her child underwent surgery, she knew it was time to pursue a new dream. Her HCCEF scholarships allow her to concentrate on her studies and plan her new future in nursing.

Rex knew about HCC long before he took his first class. He watched his siblings enroll at HCC, graduate, and find successful employment. Now, with help from HCCEF, he is able to afford his college education and follow in his family's footsteps.

In Sarah's case, her HCCEF scholarship allowed her to take four courses her first semester at HCC. She also has the flexibility to take the courses in the format she wanted, blending online and on-campus courses. She knows this assistance will help her graduate on time and continue on her path to become an elementary school teacher.

While I have highlighted three stories, there are hundreds more such examples of the difference scholarships make in students' lives. Thanks to generous donations, the HCCEF has provided \$1,770,218 in scholarship and programmatic support, ensuring many more students have the opportunity to pursue higher education.

Our donations came from community donors, employee donors, and grants. Additionally, events such as the HCC 5K Challenge Race, the President's Gala, the Silas Craft Collegians Dinner at Hunan Manor, and Vino Scholastico generated a gross revenue of \$531,967 toward our total fundraising goal. None of this success would have been possible without your support.

Thank you for ensuring the HCCEF had another successful year. I look forward to working with you in the coming year as we will continue to fund pathways to success.

Sincerely,

**Mary Cannon**  
Chairperson



## Recognition Societies

The Howard Community College Educational Foundation, Inc. is proud to honor donors who are part of its recognition societies. These members are a select group of distinguished individuals and organizations whose generosity, qualities of leadership, and commitment to the college's mission provide vital support to Howard Community College students.

The foundation extends its sincere appreciation to the following members of **The President's Circle**, who have partnered with the foundation in building relationships to promote the college and have donated more than \$100,000 to support HCC students:

<b>Bank of America</b>	<b>The Horizon Foundation of Howard County, Inc.</b>	<b>Mercedes-Benz of Silver Spring</b>
<b>Baltimore Gas and Electric</b>	<b>Peter and Elizabeth Horowitz</b>	<b>Merritt Properties</b>
<b>Boyer Gilbert Family Foundation</b>	<b>Howard Bank</b>	<b>John G. Monteabaro Foundation</b>
<b>Yolanda and Francis Bruno</b>	<b>Howard County Arts Council and the Howard County Government</b>	<b>Riparius Construction</b>
<b>Cardoni Waddell, LLC</b>	<b>Howard County General Hospital, A Member of Johns Hopkins Medicine</b>	<b>The Jim and Patty Rouse Charitable Foundation</b>
<b>CareFirst BlueCross BlueShield</b>	<b>David and Debra Huber/HRLD Foundation</b>	<b>The Rouse Company Foundation</b>
<b>Coca-Cola Refreshments</b>	<b>Bob and Bach Jeffrey</b>	<b>The Ryland Group</b>
<b>The Columbia Bank</b>	<b>The Kahlert Foundation</b>	<b>Sandy Spring Bank</b>
<b>Columbia Film Society</b>	<b>Kaiser Permanente</b>	<b>Bill and Susan Schneider</b>
<b>Community Foundation of Howard County</b>	<b>Kenneth and Marie Kittelberger</b>	<b>Fred and Sandy Schoenbrodt</b>
<b>Cosmopolitan Incorporated</b>	<b>Elizabeth and Ken Lundeen</b>	<b>James and Barbara Schulte</b>
<b>Ellicott City-Columbia Lions Club</b>	<b>Lundy Family Foundation</b>	<b>Richard B. Talkin Family</b>
<b>Cheryl Griffin</b>	<b>M&amp;T Bank</b>	<b>Barb Van Winkle</b>
<b>Rand Griffin</b>	<b>Maryland State Arts Council</b>	<b>Stephen and Brenda Walker</b>
<b>Edward and Fern Hamel</b>	<b>Patrick* and Jill McCuan</b>	<b>Wells Fargo Bank</b>
<b>Harkins Builders</b>	<b>MedStar Health</b>	<b>Work Strategy/Brian McIntyre</b>
<b>Helen P. Denit Charitable Trust</b>		<b>W.R. Grace Foundation</b>
<b>Wilson and Ann Hoerichs</b>		<b>Kathy and Jerry Wood Foundation</b>

The foundation is also deeply grateful to the following members of the **Legacy Society**. These are special friends who have remembered the Howard Community College Educational Foundation in their estate plans, made HCC the beneficiary of a retirement plan, insurance plan, or bank account, and who have invested in the future of students who will be tomorrow's pillars of society.

If you have made an estate or other planned gift to benefit Howard Community College students via the HCC Educational Foundation and have not informed us, please consider contacting Missy Matthey, executive director, at 443-518-4208 or [mmatthey@howardcc.edu](mailto:mmatthey@howardcc.edu) so you are properly recognized as a member of the Legacy Society.

<b>Anonymous</b>	<b>Dr. Kathleen Hetherington</b>	<b>Alan and Judy Ratner</b>
<b>Nancy Caplan</b>	<b>Ann Kienlen</b>	<b>Steven Sachs</b>
<b>Michael and Joanne Davis</b>	<b>Kenneth and Marie Kittelberger</b>	<b>Kenneth and Linda Solow</b>
<b>Dr. Mary Ellen Duncan</b>	<b>Benay Leff</b>	<b>Todd Thompson</b>
<b>Lawrence and Barbara Greenfeld</b>	<b>Dennis and Melissa Matthey</b>	<b>Barb Van Winkle</b>
<b>Susan Hellenbrand</b>	<b>Patrick* and Jill McCuan</b>	<b>Stephen and Brenda Walker</b>



## Naming Opportunities

The HCC campus is ever expanding and improving. If you are interested in naming a space or a building, we have opportunities starting at \$1,000 through \$2.5 million. New construction and renovations to buildings on campus are funded by capital dollars from the state and county (50/50). Therefore, 100 percent of the gifts the Howard Community College Educational Foundation receives for naming opportunities available on campus go directly to support HCC students, based on the criteria established by the donor.

Campus buildings boast the latest in green building technology, contain state-of-the-art learning spaces, and create an atmosphere for learning and collaboration.

Contact the Howard Community College development office staff at [foundation@howardcc.edu](mailto:foundation@howardcc.edu) for details on how you can contribute to building the future for HCC students!

Thank you to the following donors for creating scholarships for students through their named space during fiscal year 2018:

[Kim and Ted Davis](#)

[Michael and Joanne Davis](#)

[Engineering Solutions, Inc.](#)

[The McHugh Family](#)

[Women's Giving Circle of Howard County](#)

[W.R. Grace Foundation](#)



Science, Engineering,  
and Technology  
Building



Academic Commons

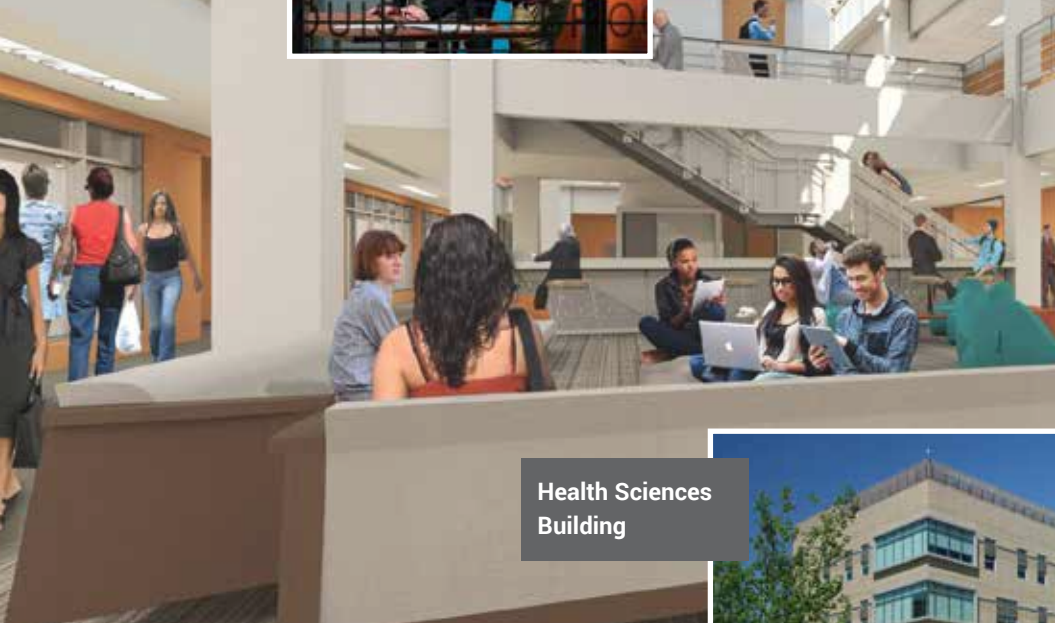

Health Sciences  
Building



## Donor Honor Roll

The Donor Honor Roll applauds Howard Community College's many friends who have given generously in support of the college's students and programs. Through their contributions, these alumni, individuals, corporations, organizations, foundations, faculty, and staff have been instrumental in helping HCC make extraordinary learning opportunities accessible to the HCC community. This honor roll reflects those donors who have made gifts and pledge payments to the Howard Community College Educational Foundation during the 2018 fiscal year.

The Howard Community College Educational Foundation, Inc. is a 501(c)(3) corporation, established with the approval of the Howard Community College Board of Trustees. The foundation provides the means for private contributions to be used for the benefit of Howard Community College students.

### Leadership Giving

*Gifts and Pledges  
Cumulative through  
June 30, 2018*

#### \$1,000,000 +

Peter and Elizabeth Horowitz  
The McCuan Family Foundation  
The Rouse Company Foundation

#### \$500,000 to \$999,999

The Horizon Foundation of Howard County, Inc.  
Howard County General Hospital, a Member of Johns Hopkins Medicine  
John G. Monteabaro Charitable Foundation  
The Kahlert Foundation  
Kaiser Permanente  
Bill and Susan Schneider

#### \$250,000 to \$499,999

Bank of America  
Coca-Cola Refreshments, Inc.  
Community Foundation of Howard County  
Ellicott City-Columbia Lions Club  
Wilson and Ann Hoerichs  
HRLD Foundation  
Kathy and Jerry Wood Foundation  
Maryland State Arts Council  
Merritt Properties, LLC  
The Ryland Group, Inc.  
Richard B. Talkin

#### \$100,000 to \$249,000

Baltimore Gas and Electric  
Boyer Gilbert Family Foundation, Inc.  
Yolanda and Francis Bruno  
CareFirst BlueCross BlueShield

The Columbia Bank  
Columbia Film Society  
Cosmopolitan Incorporated  
Dembo Jones, PC  
Cheryl Griffin  
Rand Griffin  
Edward and Fern Hamel  
Harkins Builders, Inc.  
Helen P. Denit Charitable Trust  
Howard Bank  
The Howard County Arts Council and the Howard County Government  
Bob and Bach Jeffrey  
The Jim and Patty Rouse Charitable Foundation  
Kenneth and Marie Kittelberger  
Elizabeth and Kenneth Lundeen  
Lundy Family Foundation  
M&T Bank  
Brian J. McIntyre  
MedStar Health  
Mercedes-Benz of Silver Spring  
Riparius Construction, Inc.  
Sandy Spring Bank, Inc.  
Fred and Sandy Schoenbrodt  
James and Barbara Schulte  
Barb Van Winkle  
Stephen and Brenda Walker  
Wells Fargo Bank  
W.R. Grace Foundation

#### \$50,000 to \$99,999

Actuarial Sciences Associates, Inc.  
AFCEA Central Maryland Chapter  
Apple Ford Lincoln  
Earl and Mary Armiger  
Ayers Saint Gross, Inc.  
The Bolduc Family Foundation, Inc.  
Carney, Kelehan, Bresler, Bennett and Scherr, LLP  
Clarence and Marti Carvell

Charles A. Klein & Sons, Inc.  
Edward Cochran  
Columbia Rotary Club  
Columbia Town Center Rotary Club  
Commonweal Foundation, Inc.  
Design Collective  
Chad and Ginni Dreier  
EMJAY Engineering and Construction Co., Inc.  
Galbraith-Winer Family Trust  
Hamel Builders, Inc.  
John and Kathleen Hetherington  
Honeywell Technology Solutions  
Howard Hospital Foundation  
Howard Hughes Corporation  
Humphrey Companies  
Michael and Carolyn Kelemen  
Padraic and Ellen Kennedy  
Kiwanis Club of Ellicott City  
Lewis Contractors, Inc.  
LG-TEK  
Lockheed Martin Corporation  
Mangione Family Foundation  
Vladimir Marinich and Barbara Livieratos  
Patrick\* and Jill McCuan  
Merrill Lynch and Company Foundation, Inc.  
Rebecca W. Mihelcic-Chapman  
James\* and Dessie Moxley  
Oak Contracting Corporation  
Patrick Communications, LLC  
The Paul and Ellen Gaske Foundation  
PNC Bank  
Howard and Kathy Rensin  
Rotary Club of Columbia-Patuxent, Inc.  
The Rouse Company  
SDC Group, Inc.  
Carl and Thora Strobel  
The Taylor Foundation  
Verizon Foundation  
Williamsburg Group, LLC  
Estate of Walt Witcover

### Annual Gifts and Pledge Payments

*July 1, 2017–June 30, 2018*

\* 5–9 total years of giving  
\*\* 10–14 total years of giving  
\*\*\* 15–19 total years of giving  
\*\*\*\* 20+ total years of giving

#### \$100,000 to \$999,999

The Kahlert Foundation  
Bill and Susan Schneider

#### \$25,000 to \$49,999

\*\*\* Coca-Cola Refreshments, Inc.  
\*\* Columbia Film Society  
Lillian V. Cunningham Revocable Trust

#### \$10,000 to \$24,999

\*\*\* Boyer Gilbert Family Foundation, Inc.  
Chaney Foundation  
\*\*\*\* Edward Cochran  
Columbia 50th Birthday Celebration, Inc.  
\*\*\*\* Community Foundation of Howard County  
\*\*\* Ellicott City-Columbia Lions Club  
Virginia Lee Fry  
\*\* Galbraith-Winer Family Trust  
\*\* Hamel Builders, Inc.  
\* Edward and Fern Hamel  
\*\*\* Harkins Builders, Inc.  
\*\*\*\* Peter and Elizabeth Horowitz  
\* Howard Hospital Foundation

\*\*\*\* Bob and Bach Jeffrey  
Kamal Khanna and Angeles de Leon  
\*\*\* Elizabeth and Kenneth Lundeen  
\*\*\*\* M&T Bank  
\* The Paul and Ellen Gaske Foundation  
PNC Bank  
\*\*\*\* Sandy Spring Bank, Inc.  
\*\*\* Fred and Sandy Schoenbrodt  
\* Carl and Thora Strobel  
\*\*\*\* W.R. Grace Foundation  
\* Women's Giving Circle of Howard County

#### \$5,000 to \$9,999

\*\* Derek Ammons  
Barnes & Noble College Booksellers, LLC  
\* BB&T  
\* Doug and Kyle Brooks  
\*\*\* Yolanda and Francis Bruno  
Bruce E. Campbell  
Bob and Mary Pat Cardoni  
\* Ravi and Bhuvana Chandran  
Christopher and Laura Cochran  
\* COLA, Inc.  
\*\*\* Cosmopolitan Incorporated  
\* Daycon Cleaning and Maintenance Supplies  
\*\* Design Collective  
Sal and Carol Dunn  
\*\*\*\* EMJAY Engineering and Construction Co., Inc.  
The Greenway Foundation  
Havtech  
\* Helm Family Charitable Trust  
\*\*\* John and Kathleen Hetherington  
\*\*\* Howard Bank



\*\*\* Howard County  
Economic Development  
Authority  
\*\*\*\* Howard County General  
Hospital, a Member  
of Johns Hopkins  
Medicine  
\*\* Humphrey Companies  
\*\* LG-TEK  
\* Lift Off Distribution, LLC  
\*\*\*\* Vladimir Marinich and  
Barbara Livieratos  
Ronald A. Mayer  
\*\* MedStar Health  
Neall Family  
Foundation  
\* Alfred J. Smith† and  
Bernadene Hallinan  
Smith  
Quentin Smith  
\*\*\* Kenneth and Linda  
Solow  
\*\*\* Taylor Foundation, Inc.

#### \$1,000 to \$4,999

\* 1919 Investment  
Counsel  
\* Access Demolition  
Contracting, Inc.  
African American  
Community Roundtable  
of Howard County  
\*\*\* Alpha Foundation of  
Howard County, Inc.  
Maria Anderson  
Anonymous (3)  
\*\*\* Orchard Development  
Corporation  
Bachu Charitable  
Foundation, Inc.  
\* Vivian Bailey  
\*\* Susan D. Baker  
\* Bard Family Foundation  
\*\* Anjula Batra  
Kathleen M. Berry

\*\*\* Barbara J. Bice  
\* Kimberly Bohnet  
BrightView Landscape  
Services  
\* Brown & Heim, Inc.  
\*\*\*\* Andrew and Kathryn  
Bulleri  
\* Walter and Aileen  
Bumphus  
\*\*\* Angel C. Burba  
\*\*\*\* Caplan Group, Inc.  
\*\*\* CareFirst BlueCross  
BlueShield  
\*\*\*\* Carney, Kelehan,  
Bresler, Bennett &  
Scherr, LLP  
\*\*\*\* Christopher J. Cherry  
\* Chesapeake Corporate  
Advisors  
Chesapeake Plumbing  
and Heating, Inc.  
\*\* Coalition of Geriatric  
Services, Inc.  
Edward L. and Andrea  
Cochran  
Mark and Deirdre  
Cochran  
Mary Catherine  
Cochran  
\*\*\*\* Carlton and Lynn  
Coleman  
\*\* Colonial Electric  
Company, Inc.  
\*\*\* Columbia Association  
\*\*\* Columbia Rotary Club,  
Inc.  
The Community College  
of Baltimore County  
Compass Computing  
Group, Inc.  
\*\*\* John and Donna  
Cookson  
\*\*\* Corporate Office  
Properties Trust  
Costello Construction

\* The Creig Northrop  
Team of Long & Foster  
Real Estate  
\*\*\*\* Janet and Mark Cullison  
\* Ralph Cullison  
\*\*\* Davis, Agnor, Rapaport,  
& Skalny, LLC  
\*\*\* Michael and Joanne  
Davis  
\*\*\* Decanter Fine Wines  
\*\*\*\* Dembo Jones, PC  
Christopher DeSimone  
\*\* Steven and Laurie  
Diener  
Elizabeth E. Dodson  
Steve and Miriam Dubin  
\*\*\*\* Mary Ellen Duncan and  
John Mack Kingsmore  
\* Maura Cleary Dunnigan  
\* Peggy Ecker  
\* Elkridge Rotary Club  
\* Ellicott City Rotary Club  
FAI Wealth Managment  
Allan and Linda Field  
\*\*\* First Baptist Church of  
Guilford  
\* Craig and Jennifer Flury  
Fourth Dimension  
Engineering  
Freedom Consulting  
Group  
David Gaines  
\*\* Genna & Associates,  
LLC  
Gilbane Building  
Company, Inc.  
Global HVAC, LLC  
Joel Goodman and  
Sally A. Lentz  
\* GRANIX, LLC  
\* Greenebaum  
Enterprises  
\*\*\*\* Lawrence and Barbara  
Greenfeld  
\*\* Rand Griffin  
Ron Gula  
\*\*\*\* Farida Parvez Guzdar  
\* Bert and Joan Hash  
\*\* Michael Hassett and  
Jeannette Simmons  
\* Judith Haxton  
Lilah Haxton  
Thomas L. Hicks  
George and June  
Higgins  
\*\*\* The Horizon Foundation  
of Howard County, Inc.  
Howard County  
Chamber of Commerce  
\*\* Howard County Striders  
\*\* The Howard Hughes  
Corporation  
In-Depth Engineering  
\*\*\*\* Zoe A. Irvin

\* The Jeffrey Group at  
Morgan Stanley, LLC  
\*\*\* Chuck and Anne  
Johnson  
\*\* Margaret Jane Kahlor  
\*\* Kaiser Permanente  
\* KCI Technologies, Inc.  
\*\*\* Kevin J. Kelehan  
\* Sean Keller  
\* Jonathan and Laurie  
Kigner  
\*\*\* Kiwanis Club of Ellicott  
City  
\*\*\*\* Geoffrey and Fran Kroll  
George Laniado  
\*\*\*\* Valerie E. Lash  
\* Leach Wallace  
Associates, Inc.  
\*\* Lee Financial  
Associates, LLC  
\*\* John and Betsy Lew  
\*\* Richard M. Lombardo  
\* Joan Lovelace  
The Lutheran Village At  
Miller's Grant, Inc.  
Magellan Health  
Services  
The Mall in Columbia  
\*\* Mangione Family  
Foundation  
\*\*\*\* Melissa L. Matthey  
Rashid Mayes  
\*\* Kevin and Laura  
McHugh  
Matthew M. McHugh  
Richard M. McHugh  
Suzanne M. McHugh  
\*\*\*\* Rebecca W. Milhelcic-  
Chapman  
\* Kathleen Mikszan  
\* The Miller Family  
Foundation, Inc.  
Paul and Valerie Miller  
\*\*\*\* Helen B. Mitchell  
\* Rob and Ann Moxley  
\*\* Thomas and Shelley  
Multz  
NewWave Foundation,  
Inc.  
\*\* Jeyasingh and Vinitha  
Nithianandam  
Northrop Grumman  
Old Line Bank  
\* Pandora Jewelry, LLC  
Jeanette Perin  
\* Carl and Mamie Perkins  
Patti A. Petry  
\*\*\* Kimberley J. Pins  
Plano-Coudon, LLC  
Praxis Engineering  
Technologies  
\* Prostatix Financial  
Advisors Group

\*\* Christopher Puin  
\* Republic National  
Distributing Company  
Revere Bank  
RFC, Inc.  
\*\* Riparius Construction,  
Inc.  
Aaliyah Y. Rizvi Shaikh  
\*\*\*\* Ronald and Gerry  
Roberson  
\* Roman Company, Inc.  
\*\*\*\* Rotary Club of  
Columbia-Patuxent, Inc.  
\*\* Alexander and Terry  
Ruygrok  
\*\*\*\* Steve and Lee Sachs  
S.A.F.E. Management  
\* SB & Company, LLC  
\*\*\* Christopher S. Schardt  
Shanti, Inc.  
\* Jahantab and LaRee  
Siddiqui  
\*\* Siemens Industry, Inc.  
Sill Engineering Group,  
LLC  
Michael and Madge  
Silverman  
\*\*\*\* Emily T. Slunt  
\*\* Judy Lynn Smith  
Felcita Solá-Carter  
\* St. John Properties, Inc.  
Star Flight Enterprises,  
Inc.  
\* Allen R. Stott  
\* Strategic Wealth  
Management Group,  
LLC  
\* SunTrust Mid-Atlantic  
Foundation  
\*\* Jean M. Svacina  
Swiftway Services  
Synergy ECP, LLC  
Tenable  
Trane Company, Inc.  
\*\*\* James and Verity Truby  
\*\* Turf Valley Resort &  
Conference Center  
\*\*\* Patricia Turner  
\* University System of  
Maryland Foundation,  
Inc.  
\*\*\*\* Barb Van Winkle  
Vaughn Greene Funeral  
Home  
\*\*\* Verizon Foundation  
The Vertical  
Connection, Inc.  
\* Courtney and Richard  
Watson  
\*\* Williamsburg Group, LLC  
Willis Towers Watson



VINO SCHOLASTICO

**\$250 to \$999**

AAUW of Howard County  
 Gerald Abbott and Ruth Paine  
 ADG Creative  
 Advanta Medical Solutions  
 Alan and Karen Berkowitz  
 Alkeon Capital Management  
 American Contracting & Environmental Services  
 Anonymous (4)  
 \*\*\*\* Margaret R. Armitage  
 \*\* Delton and Sherry Atkinson  
 Paul Barrett  
 \* Bernard and Lucille Bartos  
 \*\* Robin L. Bauer-Taylor  
 The Beacon Institute  
 Bethel Korean Presbyterian Church  
 Neville and Mani Bilimoria  
 \*\*\* Bruce Blum  
 \*\*\*\* Johnny Bouman  
 Bowman & Company, CPA, PC  
 Marianne Brackney  
 Brightworks Wealth Management  
 \*\* Marian Buck-Lew\*  
 \* Chris, Julie, Gracie and Sean Bulleri  
 \* Timothy Bulleri  
 Cabling Systems, Inc.  
 \* Bob and Nancy Calder  
 \* Mary E. Cannon  
 Canon Solutions America, Inc.  
 Cape Starz Wine  
 Capital Bank  
 CBG Building Company  
 \* Michael D. Cesario and Raisa Otero-Cesario  
 Hao Cheong  
 Chesapeake Lighting  
 Chipotle  
 \* Jae Im Choi  
 \* Stephen Yoon Bum Choi  
 William and Teresa Cochran  
 \* Columbia Benefits Consultants, Inc.  
 \* The Columbia Chapter of the Pierians, Inc.  
 \*\*\* Janet Moye Cornick  
 Thomas H. Cover  
 \*\* Kaye A. Craft  
 CRISP

David & Shirley Chickering Trust  
 Alan R. Davis  
 \* Jim and Suzanne Davis  
 \* Ted and Kim Davis  
 \* Kevin Doyle  
 \* Claudia S. Dugan  
 Dutch Soccer School  
 Ecoprint, Inc.  
 EMH Environmental  
 \*\*\* Roger D. Estep  
 Exelon Corporation  
 First Coast Security  
 Flagship Rental & Management, Inc.  
 Kimberly Amprey Flowers  
 \*\* Matthew Freedman and Gladys Arak  
 Trisha Frick  
 \*\*\* Yifei Gan  
 \*\* Stephen and Sherry Gardner  
 \* Robert G. Gaw  
 \* Ronald and Ellen Giles  
 \*\*\* Abigail Glassberg and Frank Staines  
 Reginald Godin  
 \*\*\*\* James and Laura Grant  
 \* Peter L. Grau  
 \* Anahita P. Guzdar  
 \* Yezdi and Perveen Guzdar  
 gymGO  
 Arlene L. Harrison  
 \* Matthew and Michele Horowitz  
 Carol Lynn Howald  
 Howard County Police Department  
 Grace, Lily, Max, Heather, and Nate Hunt  
 \*\*\* Steven and Candace Hutcheson  
 \*\* Marie R. Janiszewski  
 John and Gayle Van Horn Charitable Fund  
 Johnson, Mirmiran & Thompson  
 \* Zakia W. Johnson  
 \*\* David C. Jordan  
 \*\*\* Ed and Eileen Kaplan  
 \* Mohini Kaul  
 Paul and Anna Kim  
 \* Jennifer A. Kling  
 Klotz Karate  
 \*\* Catherine LaFerriere  
 Garry T. Laing  
 \*\* Grace M. Lee  
 \*\*\*\* Benay Leff  
 Level Landscape, LLC  
 \*\* Alisa A. Lewis

LifeSpan Network  
 Lighting Environments  
 \*\* James and Linda Loesch  
 \* Dawn Y. Lowe  
 \*\*\*\* Robert R. Marietta  
 Brad Markham  
 \*\*\*\* Janice L. Marks  
 Richard S. Marriott  
 \* Rita A. Mayhew  
 \*\* William Rand McCormack  
 \* Tom Meachum and Kari Ebeling  
 Barbara Jean Miller  
 Laurence Miller  
 Morgan-Keller Construction  
 Sue Morss  
 Robert J. Muir  
 \* Murphy & Dittenhafer, Inc.  
 \* NAACP Howard County, MD Branch  
 NAI Michael  
 \*\*\* Nancy Adams Personnel  
 Shirley I. Newsome  
 \* John and Margaret Oehrl  
 Emmanuel Oghogho  
 \* Hal and Toby Orenstein  
 Lori S. Painter  
 \* William and Elizabeth Pearce  
 \*\* Cindy Peterka  
 \* Angela R. Phillips  
 \*\*\* William and Paula Phillips  
 \* Mary C. Ratcliffe  
 \* Alan and Pamela Ray  
 \* Michael and Linda Retton  
 Stanette H. Robinson  
 \*\* The Hugh and Carole Ross Trust  
 Rule4 Building Group  
 Carol E. Runge  
 \* Barbara Russell  
 Safren Sales, Inc.  
 Oren D. Saltzman  
 \*\*\*\* Donald and Bernadette Sandruck  
 \*\* Diane E. Schumacher  
 Jennifer Sheehan  
 \*\* Nicholas Sommese and Kathryn Hogue  
 Judith A. Snyder  
 Soroptimist International  
 Mid-Atlantic Online Club  
 Southern Glazer's Wine and Spirits  
 \* John and Susan Spencer  
 SRC Technologies  
 \* Stephen and Sue Sternheimer  
 Christopher M. Taylor  
 \*\*\* Jacqueline L. Taylor

Tensley Consulting  
 Robin B. Thomas  
 \*\* James and Karen Trennepohl  
 \* Jeffrey and Susan Troll  
 \*\* William and Lorraine Tropf  
 Frank and Kimberlee Turner  
 Katie M. Turner  
 \* The URHOB  
 Association of Washington DC Metropolitan Area  
 \*\*\* Philip Vilardo and Lisa Wilde  
 \* Waldon Studio Architects & Planners PC, Inc.  
 \*\*\* Thomas Walters and Karlyn Young  
 The Wendy Slaughter Team At Next Step Realty  
 \* Minah C. Woo  
 Workstrategy, Inc.  
 \*\*\*\* Gregory and Virginia Yates  
 \* Henry and Nancy Yee  
 \* Shoekai Yeh and Hsien-Ann Meng  
 \* Nai-Chyuan and Molly Yen  
 \*\* Laura Y. Yoo  
 Patrick and Denise Youngs

D. Crystal Alford-Cooper  
 AmazonSmile Foundation  
 Grace Maria Anastasiadis  
 \* Brenda L. Anderson  
 Paul T. Anderson  
 \* Ella J. Angell  
 Anonymous (14)  
 \*\* Roy and Susan Appletree  
 \*\*\*\* Earl and Mary Armiger  
 Shamsun Nisa Asgarali-Hoffman  
 Josh Tousif Aslam  
 \* James P. Atsides and Ardell Terry  
 \* Bacchus Importers, LTD.  
 Charles M. Baines  
 \*\* James Baker and Elizabeth Lancaster  
 \* Clyde and Gloria Ballard  
 Melissa Cunha Banach  
 Beverly Barber  
 \* Anne Barker  
 Douglas and Robin Barnes  
 Denee and Quin Barr  
 Monica A Barrios  
 \*\*\* Michael and Sara Baum  
 Barbara A. Baxter  
 Tillie Bayless  
 Lewanna T. Bazemore  
 Spencer Harrison Becraft  
 Kevin M. Bell  
 Brandon Laurence Bellamy  
 Eric S. Belt  
 \* Giora and Mirrell Bendor  
 \*\*\*\* Randall R. Bengfort  
 Karina D. Bernal

**Up to \$249**

Debora Abraham  
 \*\* Harry and Deborah Adler  
 Edward Agranovski  
 Nsikan-Abasi Regina Akpan  
 Chrissandra M. Alexander

**SILAS CRAFT COLLEGIANS DINNER**



## PRESIDENT'S GALA

Michael and Verna Bernoi	Deborah A. Carr	Cathryn L. Derr	Henrietta Goodman	Larry Hughes and Pamela Isabel
* Elaine C. Bernstein	Joseph Peter Carr	*** Penny DeYoung	Neil Gordon	Bill Hunt
* Better World Books	Mary Ann Carroll	Dan and Faith Diehl	Jacqueline Greaney	Nancy C. Hutchison
Sam and Pauruchisty Bhathena	Christopher J. Carter	*** Roberta E. Dillow	** Belinda A. Green	Intersocietal Accreditation Commission
Caldwell and Rochelle Bibbs	Terrell Tyree Carter	Rachael C. Dorn	** Karen A. Green	David M. Isquith
Ilana Bittner	Wenzell and Marjorie Carter	Michael E. Dower	*** Christopher B. Greene	* Wayne and Ann Ivester
** Ellen W. Blackwell	James Cassidy	Jen Drasin	*** Patricia M. Grim	Kristin Jean-Baptiste-Simonne
Jennifer L. Blake	Susanne Marie Caviness	Katherine F. Duck	*** Albert and Judith Grollman	Kimberlee Selina Jewer
Eleanor Blanton	** William and Eileen Chalfant	*** William and Eva Duff	Donald and Kristin Grue	Allison Mariana Jimenez
Kendrick Juavonte Blizard	Sam Chalungsooth	*** Cindy V. Durham	**** Werner and Andrea Gruhl	Ashleigh Marie Johnson
Joseph Bojanowski	Bei Chhahlo	* Cecily Eidelhoch	** Deborah A. Gubisch	* Diane M. Johnston
Maryanne B. Bongiovani	* Sandra Childress Clabough	Pamela Lynn Eidsness	Natasha Hage	Maria G. Jones
** Robert and Lenora Booth	* Rufus and Doris Clanzy	Palchamy Elango	John and Susan Hailman	James Kaiser
* Gregory Bowers	Charles and Elizabeth Clark	Charles Elliott	Kathleen A. Hamilton	Go Eun Kang
Jennifer Belinda Branch	Gordon and Martha Clarkson	*** Llatetra Brown Esters	Brittany Elizabeth Handy	James Constanti Karantonis
* Frank Emile Braxton	* Peter D. Collier	*** Marilyn L. Estes	Geraldine Hanus	Manjot Kaur
* Aaron and Janelle Broderick	*** Kevin M. Collins	Beth Ann Evans	* Kelvin L. Harris	*** Linda L. Kazanow
Barbara S. Brown	Khershed Cooper	Denelle Denise Evans	James F. Hart	Sharon Keeny
** Jesse Brown	James and Alice Cornelison	Yvonne Everett	Michael A. Harvey	*** Michael and Carolyn Kelemen
Lavell Brown-Condon	*** Pamela M. Cornell	Christi Lyn Ewing	**** William and JoAnn Hawkins	* James and Deidra Kelly
*** Robert and Mary Ann Buchmeier	Brynnli Ellen Cortes	Robert and Margaret Feng	** O. Maurice Haynes	* Donna M. Kelly
* Alison E. Buckley	* Thomas and Patricia Cosgrove	Joseph Ferguson	** Dianna Heaney-Reynolds	* Deborah P. Kent
Marc Bulleri	Jim and Vicki Cramer	** Anabel and Theodore Fishman	*** Thomas and Sharon Heckler	David Kenyon
Susan Bungert	Benjamin Aaron Crews	Mark and Feroza Fitch	Joanne Heiligman	Craig and Elisabeth Kerr
* Guy G. Bunyard	* Laura J. Cripps	Cynthia Fisher	Lisa C. Heimlicher	James S. Kim
Kayla E. Burch-Strong	Floyd J. Csir	Robert A. Flack	* Aaron Heinsman	Jane Y. Kim
** Dwight and Shirley Burrill	Robin M. Cuddy	Olivia M. Fletcher	** Susan C. Hellenbrand	** Stephen and Janet Kimberling
** Susan R. Buswell	** Neil and Joyce Danzig	Andrew F. Flott	Felice Hinako Henriquez	* Christine Michelle Kirchner
** Georgene A. Butler	Willie L. Dash	* John and Dorothy Foellmer	Melvyn A. Herman	Linda S. Kirschner
James and Tauna Caffey	Daughters of the American Revolution	Erin C. Foley	Rachel Hess	* P. Delores Kiser-Mbah
Brian Campbell	Shavannah Starr Davin	Saah Forleh	* Christopher William Heston	** Bernice A. Kish
Ellen May Campbell	K. Megan Davis	**** Jean M. Frank	David Grantham Hicks	** Valerie Kitch
** Mark M. Canfield	Steven Phillip Dea	Sheila Frank	David Higgins	** Judith E. Kizzie†
Allison Carew	Marcy Del Grosso	*** David and Susan Frankel	Elizabeth J. Higgins	Shirley V. Kline
David and Alexandra Cargo	Helen Dellheim	Larissa M. Freguete	Lesley Hildebrand	** Lloyd Knowles and Elizabeth Bobo
**** Ron and Priscilla Carlson	Thomas Joseph Demmitt	* Jay Friedman	Stephen Horvath and Tara Hart	* Julie E. Knox-Brown
		Mary E. Fuson	Edith Ho	Erica Michelle Koenig
		* Nancy Galloway	Elana Hoffman	The Korean Society of Maryland
		* Louis R. Garcia	*** Richard and Lois Hollander	Allison Korn
		* John and Marge Gardner	Marcia K. Holpuch	* Susan Kramer
		** Jennifer F. Garner	* Thomas Holzman and Alison Drucker	David L. Krasnansky
		John and Cindy Garnsey	* Elizabeth S. Homan	** Michelle Lee Kreiner
		** Schnell R. Garrett	Sarah Ann Hoover	*** Robert and Glenda Kruger
		**** Margaret H. Garroway	*** Stephen Horvath and Tara Hart	Marilyn P. Kulansky
		Mitra Z. Gavvani	* Terry V. Howard	Audrey B. Kunkler
		** Willis and Doretha Gay	Torre Elise Howard	* William C. Lamb
		** Suzanne Rosch Geckle	Caroline Huang	* Frederic L. Lang
		* Les and Margaret Gesell	Shu-Ming Huang	** Martin and Beverly Lang
		* Ralph and Jane Geuder	* Aaron Tymeka Huggins	
		* James and Patti Gillespie		
		* David and Judy Glaser		
		*** Thomas Glaser		
		* John and Claudia Glover		
		Nancy Goldsmith		
		Benjamin Gong		



Donna Lange Marie LaPorte	*** Richard and Martha Matlick	*** Donna M. O'Brien Rodney Oddoye Comfort Temitope Ojo Francis Nyayieka Omondi Ekaji Osayande Nana Kwabena David Owusu-Nkwantabisa Behram and Zenobia Panthaki William T. Park John V. Parsons Rubina Patel Sulochana Patnaik
** Roger and Linda Lark	* Dennis and Faith Mauro-Huse	** Susan P. Pazornick
*** Paul and Moira Larsen Caryn Lasser Jeff and Shelley Laub	* Stephanie and Ryna May Stuart H. Maynard	** William and Kathleen Pence Logan Perkins Katherine R. Peters John and Malka Peyman * James W. Pfefferkorn Vanessa Thuy Hang Pham Jennifer Redell Phillips
*** Leonard Lazarick, Jr. and Maureen E. Kelly Linh My Le	** Patrick McAfee and Elke Reuning-Elliott	*** Richard and Christine Philips Laureat Pich
* Beth Leaman Adam David Leatherman	** Russell and Mary Louise McCall Lynn McCloskey	**** Dorothy and Kenneth Plantz Robin Platts Gary Polinsky
Bruce Leipold and Dorothea Newport	** Marjorie P. McDonald Patricia M. McGing Steffanie McKee	** Vivian L. Pollock
** Richard L. Leith Larry and Carol Levin Otto and Barbara Lewis	* Claudia L. McKoin * Alan and Patricia McLaine * Kathleen M. McSweeney	** Elsa Orley Ponce Purveen Poonevala
Shannon Tinney Lichtinger Ralph and Kathie Lillie	*** Roger Meade and Sherrie Black John Medcalf Memory Care Group, LLC Franklin Mendoza Treminio Carl A. Merritt	** Michael Dawson Popp Bahadur and Jeru Postwalla Benjamin Charles Press Bruce Press Julie V. Press Khushrow and Nancy Press Prestige Beverage Group * Clifton P. Quinn
* Kathy Lilly * Susan Linden ** Thomas J. Lis Paul and Janet Lockwood	* Barbara Hickey Miller * Susan L. Miller Dilmeher Mistry MOD Super Fast Pizza, LLC Ericka S. Moody Amanda Moore	
** Portia N. Logan Lana Charis London Michael A. Long	** Melinda J. Moore * Rosemary A. Muir Thomas Munns	
** Willis and Carolyn Lovell * William E. Lowe * Gina M. Lyon	**** Donna M. Musselman Megan R. Myers Ashwini Nagarkar Cleophius Nansubuga Sandra Eileen Naylor Network for Good Sany Ngeth * Cynthia A. Nicodemus Joanne M. Niewood Lauren Michelle Nitz John T. Nuttman	
*** John and Susan Lyons * Edward and Donna Mack * Macy's, Inc. ** Richard and Malynda Madzel Michelle Wachango Maina Barbara M. Maloney * William Manning * Angel L. Marshall * Maureen J. Marshall Cissy Martin		
*** Joseph and Virgie Mason		

## Make an Online Gift Today

Did you know that you can make a donation to the Howard Community College Educational Foundation online? It's quick, easy, secure, and every gift makes a difference. Give today at [howardcc.edu/donate!](http://howardcc.edu/donate!)

* Debra Radcliffe-Borsch Michael Benjamin Rados * Lisa F. Ragland Robert and Theresa Rahikka *** Anita Bobb Ratain ** Alan and Judy Ratner * Charles and Faith Reed * Linda K. Reed Sabrina Reed Christine Marie Reider *** Howard and Kathy Rensin Aquilla Rice ** Viola E. Rideout Guy Rinaldi Karna Rishi ** James F. Robbins Colette P. Roberts **** John and Carol Roberts Roshae Cleo-Patra Roberts *** Jim and Janet Robey Damien R. Robinson *** Stanley and Dotty Rodbell **** Harold and Jane Rodman Larry and Susan Rooner ** Irma Rosado *** Martha A. Rosen Bruce Rosenblum and Jeri Shuster Chynna Ross Rita Rubel Joan P. Ruhl Gary and Denise Saks * Franklin H. Sanders *** Allen and Kaethe Schick **** Sharon L. Schmickley ** Dennis and Sandra Schrader * Cynthia Louise Schultz * Katherine Wells	Schultz Vicki Schultz Nanette M. Schweitzer Cordae Scott * Clinton and Eleanor Sellers ** Rosalie Sellman *** Laura C. Sessions Candace Shakir Mariam Fatima Shakir *** Herbert and Madelyn Shapiro Jason Shapiro Karan Sharma Narinder Sharma *** Jane A. Sharp *** Charles and Frances Shellenberger Rochelee Shing Derek Shore ** John Siebs Harry and Gayle Siegel Sarah Rina Simon Phyllis C. Sinex Sheldon and Anne Slater Laura Ann Smith **** Nancy L. Smith Shemiah Faith Joy Smith **** George and Valerie Smith In Son Sok *** Eugenia Somers ** Tim and Ellen Sosinski Mark T. Southerland Zethene M. Spinner SpringHill Suites by Marriott Michele B. St. Ledger ** Jennifer L. Stanford ** Sylvia B. Stanford Laura Steele Mik'yla Stephens Donald Stewart * Eric P. Stewart **** Margaret M. Strahan Adrienne Summers Shawn Michael Suser
---	---

### HCC 5K CHALLENGE RACE





Suzanne Suter-Lowe	*** Sharon P. Weiss	<b>Gifts In-kind</b>	Farida Parvez Guzdar	Ellen Sowry
**** Susan Keach Sweeney	** Charles V. Wendal	<i>The Howard Community College Educational Foundation would like to express its appreciation to the following companies and individuals who provided in-kind services or donations to help the foundation reduce its event and operating expenses throughout the year. Thank you!</i>	Hamilton Jewelers	Alice A. Stanford
Daniel P. Syed	Valerie Shenkle Wetstone	Absolutely Perfect Catering, Inc.	Hunan Manor Restaurant	Roger Stott
* David Tannous	Darron L. Wheeler	Sarah F. Angerer	Jailbreak Brewing Company, LLC	Jacqueline L. Taylor
Zenobia F. Taraporewala	Lydia White	Anonymous	Zakia W. Johnson	Team Kinnear
* Marcia Thomas	Victor White	Charles M. Baines	Chuck and Anne Johnson	Tino's Italian Bistro and Wine Bar
Noreen Thomas	Angeline L. Whittaker	The Baltimore Sun Media Group	Maria G. Jones	David M. Tirpak
*** Scott M. Thomas	** Anita Wilcox	Tyrone Eugene Boyd	Julie E. Knox-Brown	Margaret W. Tricoli
David M. Tirpak	* Monika Willging	The Breakfast Shoppe	Kupcakes & Co.	Turf Valley Resort & Conference Center
David Tiscione	Rosemary C. Williams	Naomi Brodsky	La Prima Food Group, Inc.	Catherine Weston
** Charles P. Toth	Ruth Wilson	The Business Monthly, Inc.	Tara Logan	The Wine Bin
David M. Trabilsy	Winegrad, Hess, Friedman & Levitt, LLC	Kim Butler	Patricia Sawyer Lundelius	Richard T. Wright
Vicky L. Trail	* Ed Wood and Dee Sullivan	Bob and Nancy Calder	LVPA, Trattoria Romana	
* Eric Treibman	Michele Kyong Woods	Kathleen Charters	Vladimir G. Marinich	
* Margaret W. Tricoli	** Tom Wright and Beth Singer	Columbia Association	Stephanie and Ryna May	
Howard W. Tucker	Sarah W. Yaroslaski	Kaye A. Craft	Tom Meachum and Kari Ebeling	
Tuttle Group International Inc.	Meilee Yin	Jessica Noelle Dalrymple	Mary Jo Messenger	
Ryan Umberger	* Amelia C. Yongue	K. Megan Davis	Osiris Therapeutics, Inc.	
Ronnie C. Urbont	Cem Yucesoy	Ted and Kim Davis	Pandora Jewelry	
*** Patricia K. Van Amburg	Gabriela Angelica Zandonadi Diniz	Delta Kappa Gamma	Jennifer Redell Phillips	
Matthew Joseph Van Hoose	Gloria Zayas	Eileen Diggs	Michael Dawson Popp	
Delia Velculescu	Rachel Zhang	Donald and Caroline Disney	Princeton Sports of Columbia	
Maria Virjee	Nicholas Zirkle	Ecoprint, Inc.	Putting on the Ritz Catering	
Ute Von Mehlem	Phyllis S. Zolotorow	Edward Arthur Jewelers, Inc.	Debra Radcliffe-Borsch	
Ann L. Von-Lossberg		Jean and Penny Friedberg	April M. Rimp	
Lynn P. Voyton		Giant Food	Guy Rinaldi	
Wagener Lee, LLC			James F. Robbins	
* William and Eileen Walker	<b>Government Grant</b>		Stanette H. Robinson	
Gordon Allen Wall	Howard County Arts Council and the Howard County Government		Richard Roepke	
Sheng-Tsung Wang	Maryland State Arts Council		Charalyn Rogers-Nado	
Taylor Ann Washington			Cynthia Louise Schultz	
Elizabeth A. Watson			John David Sheehan	
* Lee Waxman			Charles and Frances Shellenberger	
			Smokin' Hot Bar & Grille	

*The Howard Community College Educational Foundation annual report information was prepared by the HCC development office staff. It reflects HCCEF accomplishments during fiscal year 2018, which began July 1, 2017 and ended June 30, 2018. Gifts received after July 1, 2018 will be acknowledged in next year's annual report. All names have been carefully reviewed. However, errors and omissions may occasionally occur. If we have made an error, please notify us at 443-518-1970. Thank you.*

## STATEMENT OF FINANCIAL POSITION

AS OF JUNE 30, 2018 (audited)

### ASSETS

Cash and cash equivalents	\$368,835
Investments	13,032,821
Interest in irrevocable trust	129,462
Contributions receivable, net	257,031
Prepaid expenses and other assets	37,247

**TOTAL ASSETS** **\$13,825,396**

## LIABILITIES AND NET ASSETS

### LIABILITIES

Accounts payable and sales tax payable	\$740
Due to Howard Community College	71,669
Deferred revenue	87,954

**Total Current Liabilities** **\$160,363**

### NET ASSETS\*

Unrestricted	\$1,906,375
Temporarily restricted	3,587,910
Permanently restricted	8,170,748

**Total Net Assets** **\$13,665,033**

**TOTAL LIABILITIES AND NET ASSETS** **\$13,825,396**

\*Endowed assets total \$10,527,733